

TECHNICAL DATA SHEET-DansnECO

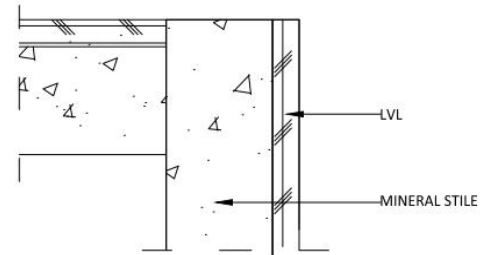
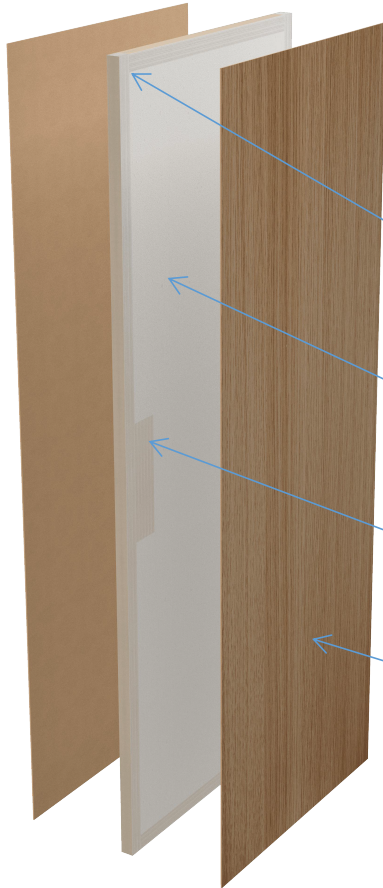

DETAIL A

LVL STILE AND RAIL

(90°JOINT) DETAIL A

DANSN MINERAL CORE(WHITE COLOR)

LVL LOCK WOOD

HDF WITH FACE FINISH

(ON BOTH SIDE OF THE DOOR
MELAMINE/VENEER/PAINTING)



DOOR SEAL

HDF WITH FACE FINISH

(ON BOTH SIDE OF THE DOOR
-MELAMINE/VENEER/PAINTING)

ENGINEER WOOD DOOR FRAME

L-shape engineered wood architrave

(WITH MELAMINE/VENEER/PAINTING)

FEATURES

Door shutter thickness	: 45mm
Core	: Miniral core + LVL
Finish Type	: Melamine/Veneer/Painting
LVL Stile	: Density 720KG/m ³
Stile and Rail Joints	: 90° Joint
Weight	: Approximately 75.5KG for the door leaf(size 2300*1100mm)
Adhesive	: Water Borne Adhesive for permanent pressure bond
Frame	: Plywood+HDF
Fire Ratings Standards	: BS 476-22:1987, BS 476-30:1987 Fire rating upto 60min Plywood : 1000N
Screw Holding Capacity (GB/T 17657-2013)	: Mineral Stile : 850-900N LVL+Mineral Stile : 1200N

Mineral Technical Specification:

Core	: Miniral core
Density	: 450-550KG/m ³
Moisture Content	: 8-10%
Hardness	: 3.72MP
Maximum Service Temperature	: 1100°C
Compressive Strength	: 3.72MP
Modulus of Rupture	: 1.16MP
Detrermination of bending strength	: 1.16MP
Determination of flexural	: 1.16MP
	: Expansion rate : 0.95%
Water resistant	: Water absorption : 133%